

All the rain we had in April makes the May flowers grow. This block looks like we will be making lots of half-square triangles and have lots of pieces, but we have shortcuts that make it fast and easy!

May 2013 *Tip Toe Through the Tulips*



12 inch finished block

We Supply:	You Supply Flower and Leaf fabrics:
Off White background: 1 strip 2 1/2" 1 2 1/2" X 4 1/2" rectangle	From Three different flower colors, cut : 1 2 1/2" X 4 1/2" rectangle for each flower 2 2 1/2" X 2 1/2" squares for each flower From Three different green leaf colors, cut: 3 - 2 1/2" X 4 1/2" rectangle for leaf 1 and 3 2 - 2 1/2" X 4 1/2" rectangle for leaf 2 2 - 2 1/2" X 2 1/2" squares for each leaf

Fabric Prep

1. Cut the 2 1/2 inch strip of off-white into 9 rectangles, 2 1/2" X 4 1/2".
2. Draw a diagonal line on the wrong side of each 2 1/2" flower squares and the 2 1/2" leaf squares.

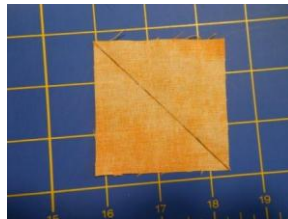

Flying Geese

We will make traditional flying geese.

3. Place one colored 2 1/2" square on the top of one of the off white rectangles with right sides together and the diagonal slanting down from left to right (as shown below). Sew along the diagonal line. Hint: Sew slightly off the line toward the outer corner and the unit so the finished goose will measure a more accurate 2 1/2" X 4 1/2". Cut 1/4" away from the sewn line and press toward the corner.

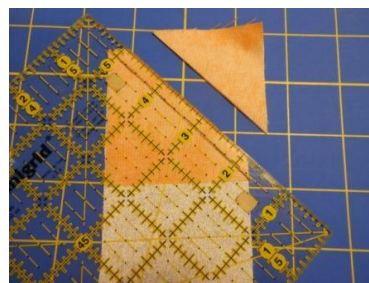

- Place a matching colored 2 1/2" square on the lower portion of the rectangle with rights sides together and the diagonal going down from right to left (in the opposite direction as the first diagonal -shown below). Sew along the diagonal line as described in step #3. Cut 1/4" away from the sewn line and press toward the corner.

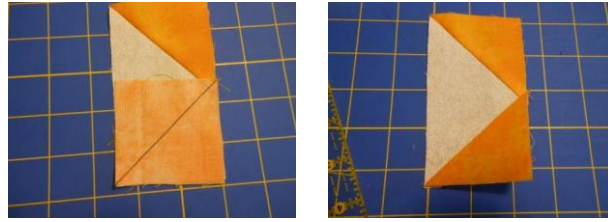

- Square up this unit to measure 4 1/2" X 2 1/2". Repeat steps 3 and 4 for each flower color and for each leaf color. Place all 6 completed flying geese units to one side.

Leaf Stem:

- Using one 2 1/2" X 4 1/2" green rectangle, fold the rectangle lengthwise and sew a scant 1/4 inch from the edge, creating a tube. Turn the tube right side out by attaching a safety pin to one end and pushing in into the tube. Press the turned tube flat with the seam in the middle of one side. Repeat for remaining two leaf colors. The finished size of the stems should be approximately 1" X 4 1/2"

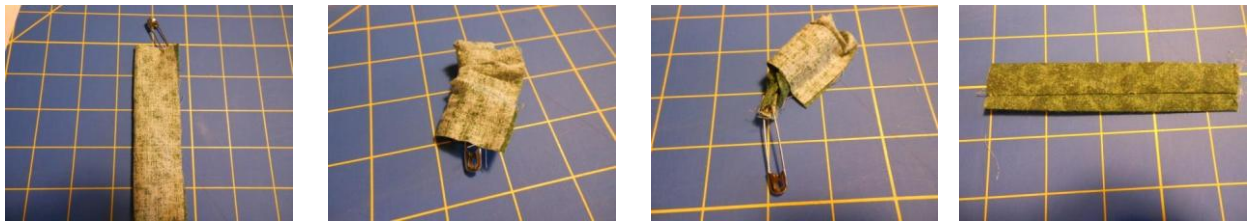

Leaf Unit

- Sew one green flying geese unit to one off white 2 1/2" X 4 1/2" rectangle as shown below.

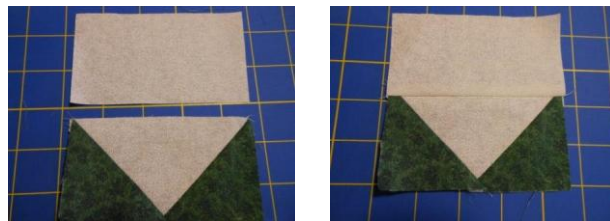

- Pin the matching tube down the center of this unit. Attach the tube to the unit using your favorite appliqué technique – by hand or by machine using a zig zag stitch with matching thread. Repeat steps 7 and 8 for the other two green flying geese for a total of 3 units.



Flower Units

9. Place one flower flying goose and its matching 4 1/2" rectangle with right sides together as shown below. Sew with a scant 1/4 inch seam.

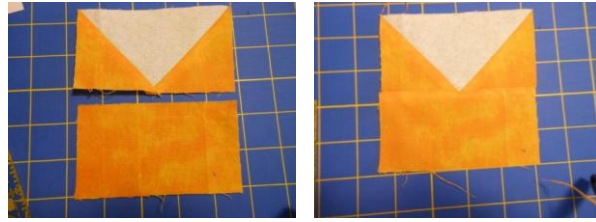

Assembly:

10. Assemble all units as shown below using a scant 1/4 inch seam.

