

January 2013 Snowflake



12 inch finished block

We Supply:	You Supply:	
From the 2 1/2 inch strips medium blue: Cut 8 2 1/2" squares Cut 8 2 1/2" X 4 1/2" rectangles	Jewel Tone Dark Blue Cut 8 2 1/2" squares Cut 1 3" X 12 1/4" strip	White or WOW Cut 8 2 1/2" squares Cut 1 3" X 12 1/4" strip Cut 1 4 1/2" square

Make 8 Half Square Triangles (HST):

1. On the wrong side of the white 3 inch strip, draw a horizontal line every 3 inches, dividing the strip into 4 squares (there may be a small amount leftover. This can be cut off and discarded after sewing). Next, draw a diagonal line on each square, starting at the lower left corner of the first square to the upper right corner of that square. Continue drawing diagonal lines from this point to the lower right corner of the second square, connecting the horizontal lines and making a zigzag across the strip.

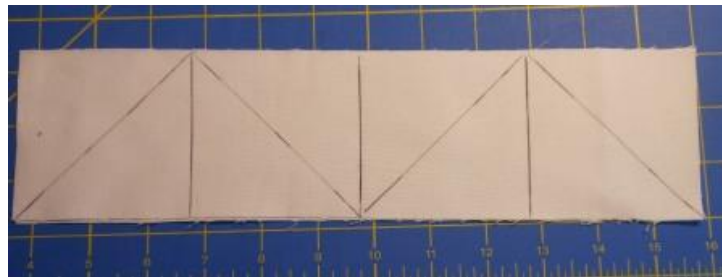

2. Place this strip on top of the dark blue strip with right sides together. Sew a scant 1/4 inch on one side of the diagonal line zigzag, then a scant 1/4 inch along the other side.

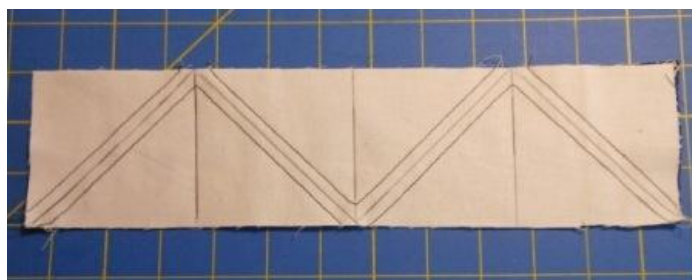
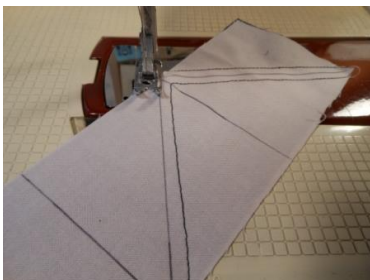

- Cut on the drawn line and press seams to dark side. Trim to measure $2\frac{1}{2}$ inches square. You will have 8 half square triangles when done.

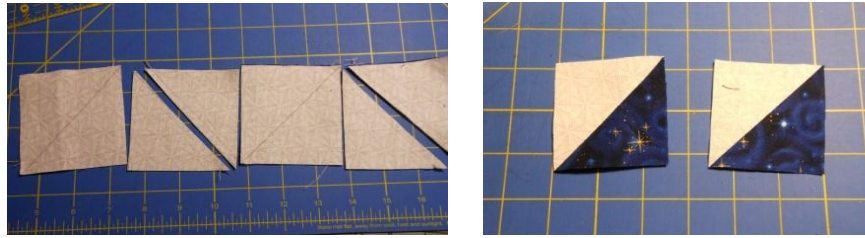

- Sew two HST and two medium blue $2\frac{1}{2}$ " squares into a unit shown below. This unit should measure $4\frac{1}{2}$ " square. Repeat 3 more times for a total of 4 units.

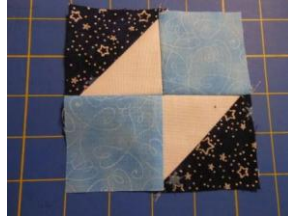

Make Flying Geese:

- Draw a diagonal line on the wrong side of each $2\frac{1}{2}$ " white square.

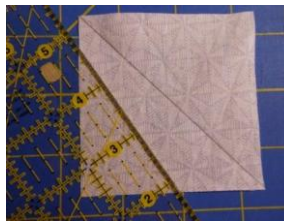

- Place one white square on the left side of one medium blue rectangle with right sides together. Sew along the diagonal line. Hint: Sew slightly off the line toward the outer corner and the finished unit will measure a more accurate $2\frac{1}{2}$ " X $4\frac{1}{2}$ ".



- Cut $\frac{1}{4}$ " away from the sewn line and press open toward the white fabric.

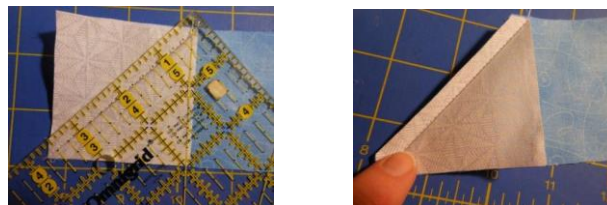

- Place a second white square on the right side of the rectangle with rights sides together and repeat step #2. Trim $\frac{1}{4}$ " from the sewn line and press open toward the white fabric.



9. Square up unit to measure $4\frac{1}{2}'' \times 2\frac{1}{2}''$. Repeat 3 more times and place all 4 completed flying geese units to one side.
10. Repeat steps 5-9 using the Dark Blue $2\frac{1}{2}''$ squares and the remaining medium blue rectangles.

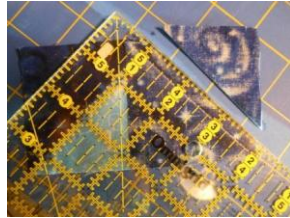

11. Sew one dark blue flying goose with one white goose as shown below. Repeat for the rest of the flying geese. You will have 4 units.



Sew units together (using the $4\frac{1}{2}$ inch white center) in three rows using all scant $\frac{1}{4}''$ seams, as shown below. Press seams in alternating directions by row. The completed block should measure $12\frac{1}{2}'' \times 12\frac{1}{2}''$.

